

ITEM	PART NUMBER	DESCRIPTION	QTY	COMMENTS
1	MT5112 3189 23	FLANGE (2" BSP)	1	
2	MT0544 2162 00	GREASE NIPPLE	1	INCLUDED
3	MT550 530 21	O-RING	2	INCLUDED

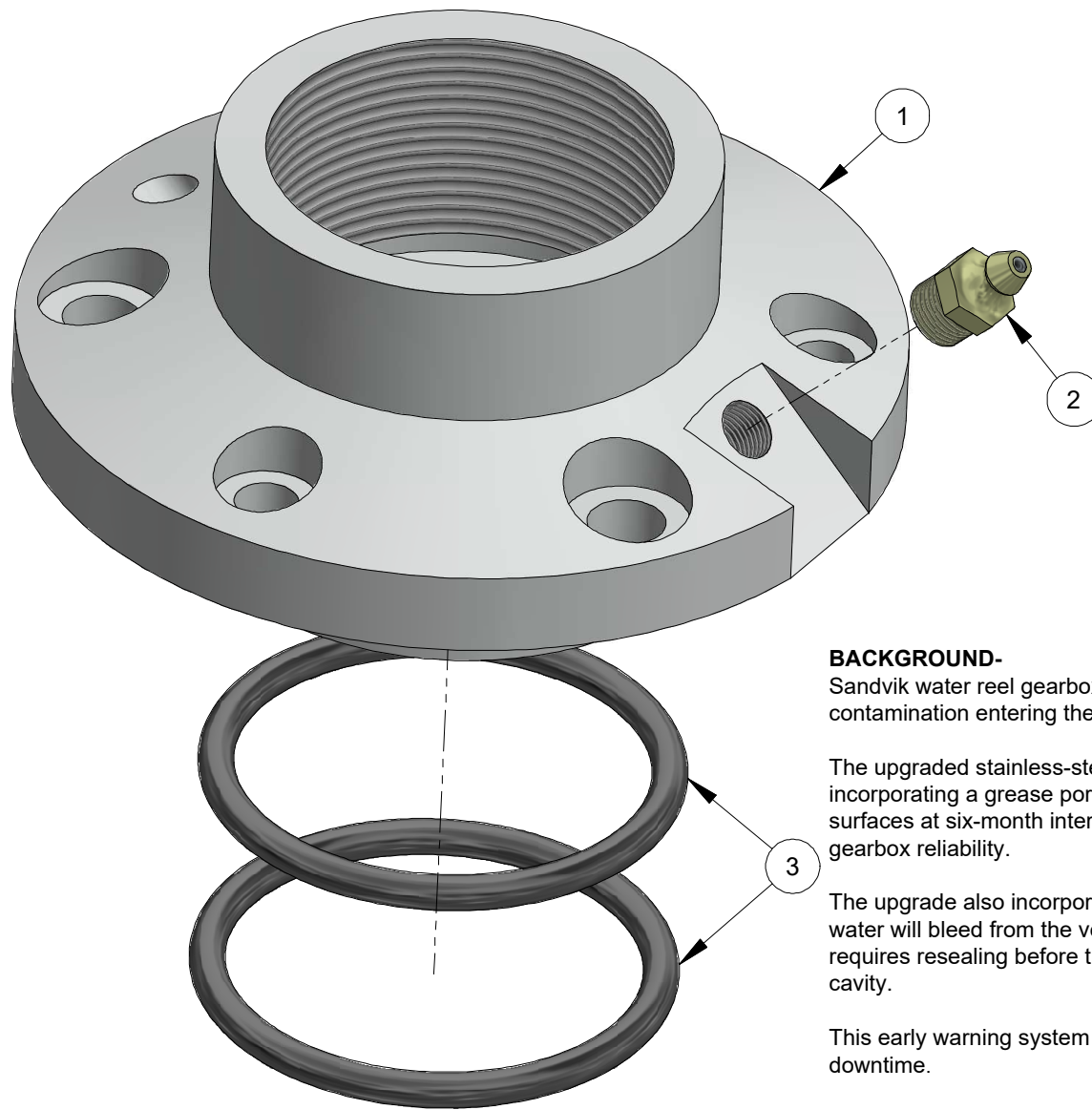

BACKGROUND-

Sandvik water reel gearboxes commonly experience failure due to water contamination entering the gearbox cavity when the flange seal leaks.

The upgraded stainless-steel flange has been designed to address this issue by incorporating a grease port, allowing grease to be applied between the sealing surfaces at six-month intervals. This significantly extends seal life and improves gearbox reliability.

The upgrade also incorporates a vent port. Should the primary seal begin to fail, water will bleed from the vent, providing a clear visual indication that the unit requires resealing before the secondary seal fails and water enters the gearbox cavity.

This early warning system helps prevent costly gearbox damage and unplanned downtime.

PART NUMBER	DESCRIPTION
MT550 351 56	FLANGE (2" BSP)
 	MT Parts: 0407 059 610 1 Haehy Circuit, Roseworthy S.A. 5371 171 Dugan Street, Kalgoorlie W.A. 6430 parts@mtunderground.com www.mtunderground.com